



Product Overview

The AX-VGS range of gas solenoid valves for use in standard applications. The valves are normally closed and come with both Automatic and Manual reset versions. The valves are typically used for emergency shut-off applications, upon power failure the valves will close until power has been restored. The standard voltage is 230Vac but both 24 and 12 Vac/dc versions are available.

Features

- EN 161, Class A, Group 2 European approved
- Various AC and DC versions available
- Screwed and Flanged Versions
- Manual or Auto reset versions

Product Specifications

Reset:	Manual	AX-VGS-GRC-
	Automatic	AX-VGS-GNC-
Power Supply:	AX-GxC-8xx	230Vac @50Hz +10 -15%
	AX-GxC-4xx	24Vac/dc @50Hz +/- 10%
	AX-GxC-2xx	12Vac/dc @50Hz +/- 10%
Operation:		Normally Closed
Max Consumption:		See table
Response Time:		≤ 1 sec
Ambient Temp. Range:		-15 to +60°C
Coil Temperature:		70°C approx
Materials:	Body	Die cast Aluminium
	Seals	NBR (UNI4916-74)
	Pressure Spring	AISI 302 Steel
	Plug	Chromium -plated Fe 37 Steel
Protection:		IP54
Connection:	15 to 50mm	DN (BSP) female threads
	65 to 100mm	Flanged PN 16
Electrical Connection:		PG11
Conformity:		CE marked
Country of Origin:		Italy

Order Codes

Screwed Valves (Insert N or R for automatic or manual reset)

AX-VGS-GxC-815	1/2" BSP Gas Solenoid valve 230 Vac coil
AX-VGS-GxC-820	3/4" BSP Gas Solenoid valve 230 Vac coil
AX-VGS-GxC-825	1" BSP Gas Solenoid valve 230 Vac coil
AX-VGS-GxC-832	1 1/4" BSP Gas Solenoid valve 230 Vac coil
AX-VGS-GxC-840	1 1/2" BSP Gas Solenoid valve 230 Vac coil
AX-VGS-GxC-850	2" BSP Gas Solenoid valve 230 Vac coil

AX-VGS-GxC-415	1/2" BSP Gas Solenoid valve 24 Vac/dc coil
AX-VGS-GxC-420	3/4" BSP Gas Solenoid valve 24Vac/dc coil
AX-VGS-GxC-425	1" BSP Gas Solenoid valve 24 Vac/dc coil
AX-VGS-GxC-432	1 1/4" BSP Gas Solenoid valve 24 Vac/dc coil
AX-VGS-GxC-440	1 1/2" BSP Gas Solenoid valve 24 Vac/dc coil
AX-VGS-GxC-450	2" BSP Gas Solenoid valve 24 Vac/dc coil

AX-VGS-GxC-215	1/2" BSP Gas Solenoid valve 12 Vac/dc coil
AX-VGS-GxC-220	3/4" BSP Gas Solenoid valve 12 Vac/dc coil
AX-VGS-GxC-225	1" BSP Gas Solenoid valve 12 Vac/dc coil
AX-VGS-GxC-232	1 1/4" BSP Gas Solenoid valve 12 Vac/dc coil
AX-VGS-GxC-240	1 1/2" BSP Gas Solenoid valve 12 Vac/dc coil
AX-VGS-GxC-250	2" BSP Gas Solenoid valve 12 Vac/dc coil

Flanged Valves

AX-VGS-GxC-865	2 1/2" Flanged Gas Solenoid valve 230 Vac coil
AX-VGS-GxC-880	3" Flanged Gas Solenoid valve 230 Vac coil
AX-VGS-GxC-8100	4" Flanged Gas Solenoid valve 230 Vac coil

Installation

NOTE:

Always mount the valve with the coil in the upright vertical position, not up side down. Valves can be mounted either horizontally or vertically, but Horizontal is preferred.

1. The valve should be installed downstream of the gas meter and outside the area traversed by the gas pipe work.
2. **The valve must be protected from rain if installed outside.**
3. Pipe work must be clean and free of any residues from soldering, tapping or threading.
4. Valve body is marked with an arrow which indicates the direction of gas flow. Ensure correct orientation.
5. Ensure there is sufficient space for Circulation of air around the valve and for maintenance access
6. Do not use the solenoid valve for leverage as this may cause damage. Only use the valve body.

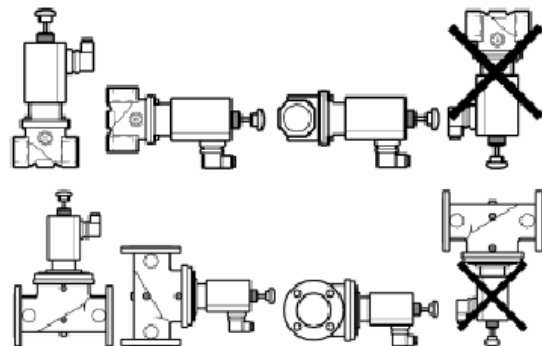

Every effort has been taken in the production of this data sheet to ensure it's accuracy. Axio can not, however, accept responsibility for any damage, expense, injury, loss or consequential loss resulting from any errors or omissions. Axio has a policy of continuous improvement and reserves the right to change this specification without notice.

Specification

	Auto Power Cons Watts	Manual Power Cons Watts	Auto Pressure Max mbar	Manual Pressure Max mbar	Orifice Diameter m m	Flow m3/hr @ P drop 0.5mbar	Flow m3/hr @ P drop 1mbar
AX-VGS-GxC-815	25	25	200	500	18	2.8	4
AX-VGS-GxC-820	45	25	360	500	27	5.5	8
AX-VGS-GxC-825	45	25	360	500	27	8.3	13
AX-VGS-GxC-832	80	25	360	500	45	14	20
AX-VGS-GxC-840	80	25	360	500	45	19	28
AX-VGS-GxC-850	80	25	360	500	56	27	40
AX-VGS-GxC-415	16	25	200	500	18	2.8	4
AX-VGS-GxC-420	30	25	200	500	27	5.5	8
AX-VGS-GxC-425	30	25	200	500	27	8.3	13
AX-VGS-GxC-432	65	25	200	500	45	14	20
AX-VGS-GxC-440	65	25	200	500	45	19	28
AX-VGS-GxC-450	65	25	200	500	56	27	40
AX-VGS-GxC-865	190	25	200	500	80	55	80
AX-VGS-GxC-880	190	25	200	500	80	73	100
AX-VGS-GxC-8100	280	45	200	500	100	110	160

Pressure drop

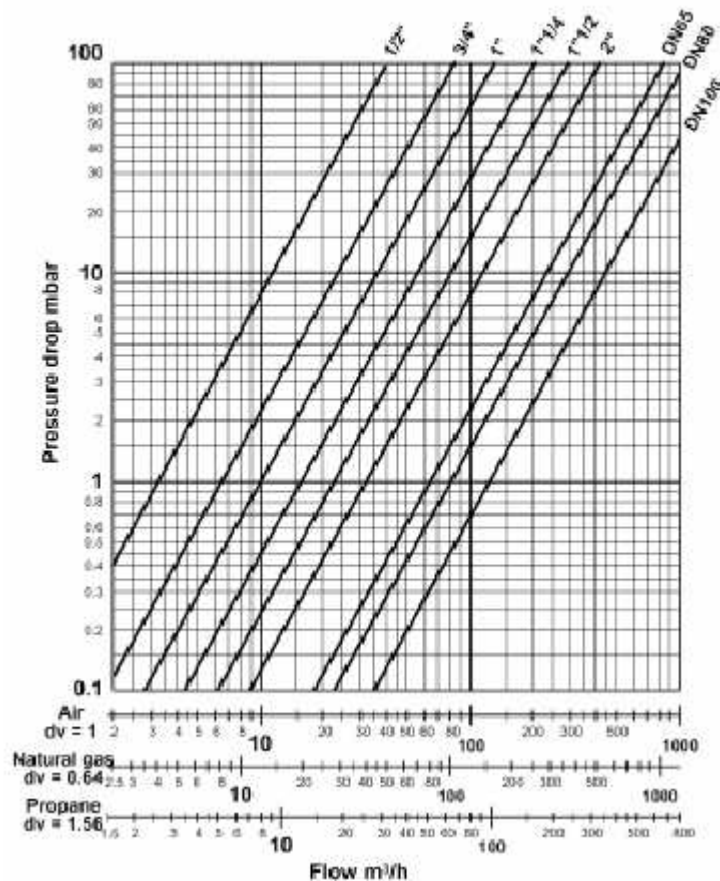

AX-VGS - Issue 1.1 - Date 06/11/2012

Unit 21, Highview, High Street, Bordon, Hampshire. GU35 0AX.
Tel: +44 (0)1420 487788 Fax: +44 (0)1420 487799
Email: sales@axio.co.uk
www.axio.co.uk

Dimensions

-GRC Manual Reset Valve

Type	d DN	A mm	B mm	C mm	D mm	E mm	G mm	H mm	Wt kg
..15	1/2"	77	22	83	164	18	-	-	1.1
..20	3/4"	96	22	83	180	25	-	-	1.5
..25	1"	96	22	83	180	25	-	-	1.5
..32	1 1/4"	153	22	83	220	35	-	-	2.4
..40	1 1/2"	153	22	83	220	35	-	-	2.4
..50	2"	156	22	83	230	39	-	-	2.7
..65	65	305	22	83	340	90	4 x 18	145	7.6
..80	80	305	22	83	340	90	8 x 18	160	7.6
..100	100	350	40	110	405	130	8 x 18	180	17

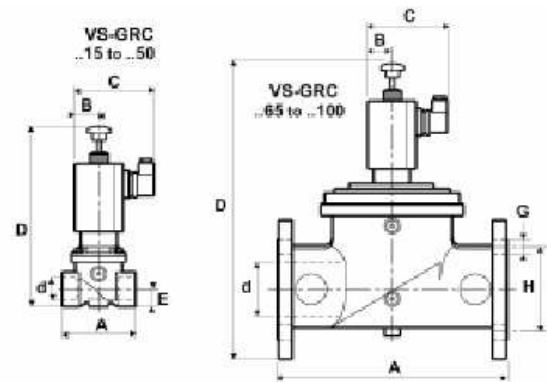

Dimensions

-GNC Automatic Reset Valve

Type	d DN	A mm	B mm	C mm	D mm	E mm	G mm	H mm	Wt kg
..15	1/2"	77	33	96	140	18	-	-	1.4
..20	3/4"	96	44	108	164	25	-	-	2.5
..25	1"	96	44	108	164	25	-	-	2.5
..32	1 1/4"	153	51	128	220	35	-	-	5.7
..40	1 1/2"	153	51	128	220	35	-	-	5.7
..50	2"	156	51	128	230	39	-	-	6
..65	65	308	58	143	355	85	4 x 19	145	13
..80	80	308	58	143	355	85	8 x 19	160	13
..100	100	350	80	188	492	130	8 x 19	180	37

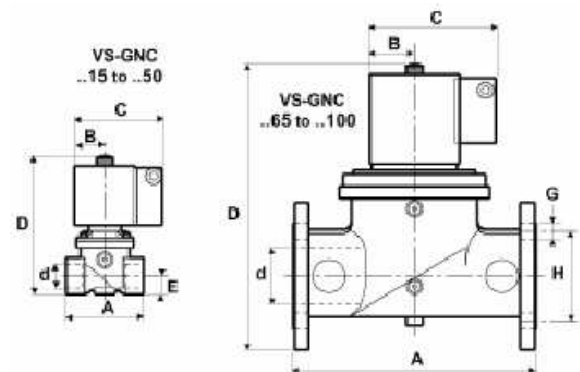

Connections

The power cable must be connected to the two poles of the rectifier terminal block housed in the wiring box. The 24V valves at the junction box there are two inputs marked with the symbols "L, N", e "+, -". AC supplies should be connected to 'L' and 'N' whilst DC connects to '+' and '-' observing the correct polarity.

During normal operation of the gas valve the surface temperature of the coil can reach 70 °C.

Ensure that this is considered when selecting suitable supply cables and the positioning of the valve.